

△ REQUIRES ITEM 8 OR 9

TO-PBL-46
TO-PBL-47
TO-PBL-47-MIDX
TO-PB2L-46
TO-PB2L-47
TO-PB2L-47-MIDX

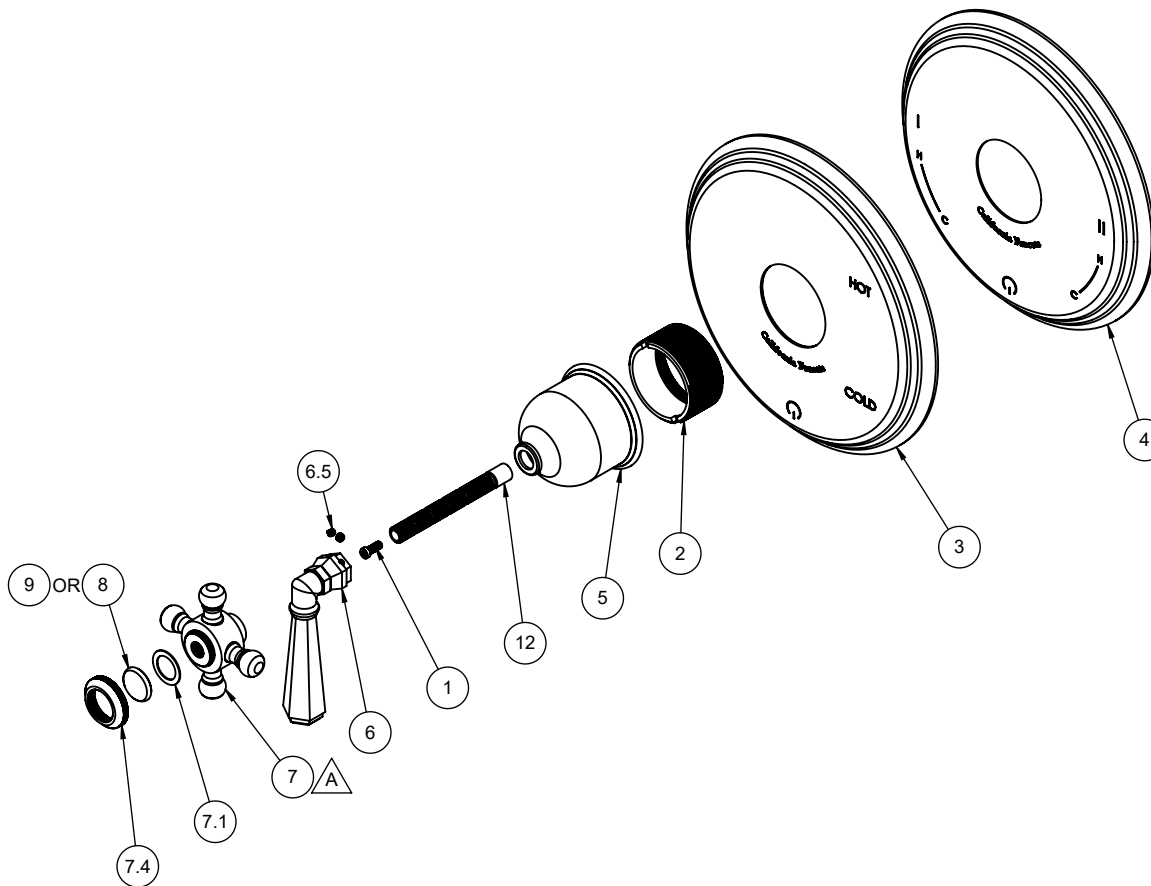

ITEM	PART NO.	DESCRIPTION	QTY
1	86078-90	SCREW, M4 X 0.7 X 10MM, w/Ø5.80 PHL PH HD SS	1
2	10292-98	BUSHING, PB G2	1
for TO-PBL	3	7-100105-ZZ ASM, TRAD PB PLATE & GASKET	1
for TO-PB2L	4	7-100546-ZZ ASM, TRAD PB2 PLATE & GASKET	1
	5	10293-ZZ ESCUTCHEON, TRAD, PB G2	1
for 46 Series	6	7-473124-ZZ KIT, MET LEV HDL, 46 SERIES (incl. 6.5)	1
	6.5	86030-WW SETSCREW 8-32 X 1/8 SCKT HD CUP PT SS	2
for 47 Series	7	7-473558-ZZ KIT, HANDLE, POST, SCREWS, SPOKES 47 W/S (incl. 7.1, 7.4, 6.5)	1
	7.1	87136-80 WSHR Ø14.00 X Ø20.50 X 0.60MM	1
	7.4	471048-ZZ HANDLE, 47, CROSS, RING	1
for 47 Series	8	471071-40 BUTTON, INDEX, 47, BLANK, PORC (Ø20 X 5.5MM)	1
for 47-MIDX Series	9	471168-ZZ BUTTON, INDEX, METAL	1
for ITEM 6.5	10	882042-99 KEY, ALLEN, 5/64", BLACK	1
	12	880137-98 BROACH EXTENSION 3-1/4"(L) X 16T(M) X 20T(F)	1